

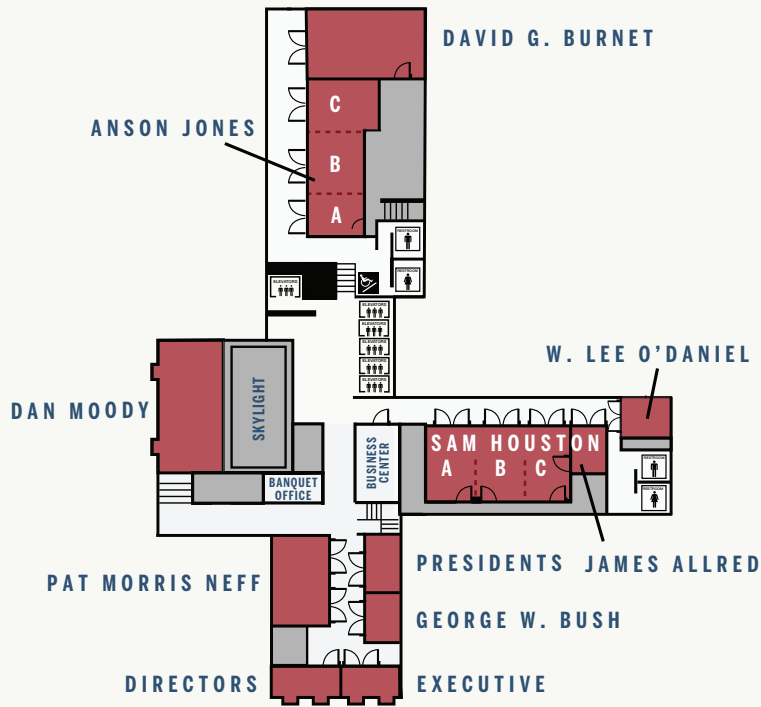

MEZZANINE LEVEL

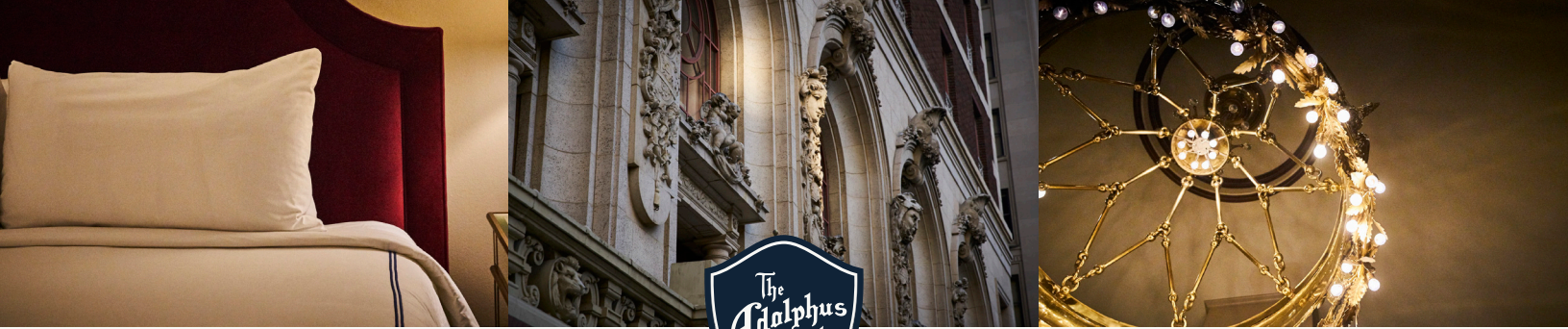

FUNCTION ROOM	SQ. FEET	DIMENSIONS	THEATRE	CLASSROOM	U-SHAPE	CONFERENCE	RECEPTION	ROUNDS OF 8	CEILING
DAVID G. BURNET	989 ft.	23' x 43'	110	50	35	40	90	80	8'4"
ANSON JONES ABC	1305 ft.	60' x 20'	150	70	45	54	150	120	7'11"
ANSON JONES A	380 ft.	19' x 20'	24	16	12	18	30	30	7'11"
ANSON JONES B	435 ft.	22' x 20'	60	30	24	24	40	50	7'11"
ANSON JONES C	490 ft.	19' x 26'	60	30	15	24	40	40	7'11"
DAN MOODY	1222 ft.	23' x 52'	110	60	35	40	100	80	8'
PAT MORRIS NEFF	1044 ft.	43' x 24'	110	60	35	40	100	80	8'10"
DIRECTORS	282 ft.	24' x 12'	n/a	n/a	n/a	10	n/a	n/a	8'10"
EXECUTIVE	322 ft.	23' x 14'	n/a	n/a	n/a	12	n/a	n/a	8'10"
GEORGE W BUSH	263 ft.	19' x 14'	n/a	n/a	n/a	10	n/a	n/a	8'10"
PRESIDENTS	294 ft.	24' x 12'	n/a	n/a	n/a	10	n/a	n/a	8'10"
SAM HOUSTON ABC	1315 ft.	54' x 24'	100	70	45	54	150	100	8'10"
SAM HOUSTON A	408 ft.	17' x 24'	30	20	12	18	20	30	8'10"
SAM HOUSTON B	504 ft.	21' x 24'	30	20	12	18	40	40	8'10"
SAM HOUSTON C	403 ft.	17' x 24'	30	20	12	18	40	30	8'10"
JAMES ALLRED	289 ft.	17' x 17'	25	15	12	14	30	20	8'10"
W. LEE O'DANIEL	361 ft.	19' x 19'	n/a	n/a	n/a	8	n/a	n/a	9'4"



BALLROOM LEVEL

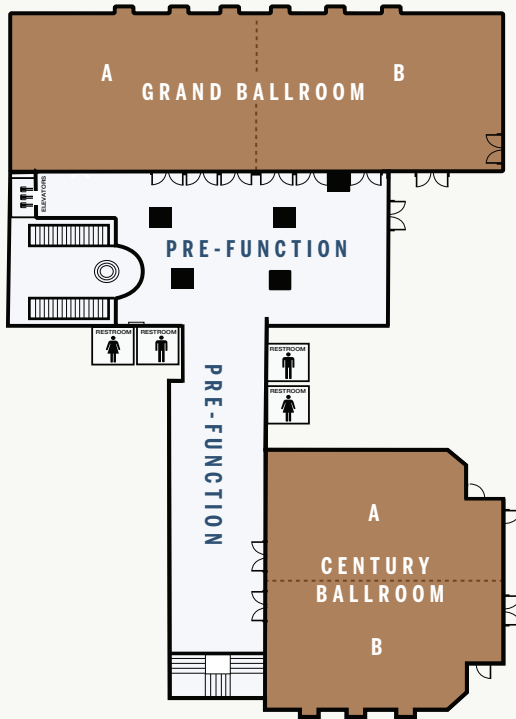

REGISTRATION LEVEL

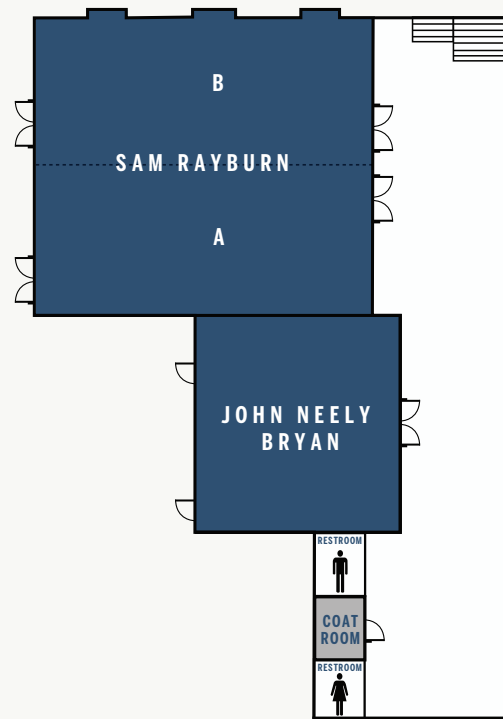

FUNCTION ROOM	SQ. FEET	DIMENSIONS	THEATRE	CLASSROOM	U-SHAPE	CONFERENCE	RECEPTION	ROUNDS OF 8	CEILING
GRAND BALLROOM AB	5304 ft.	38' x 138'	800	375	150	132	800	540	20'6"
BALLROOM A	2652 ft.	38' x 69'	400	180	70	60	400	270	20'6"
BALLROOM B	2652 ft.	38' x 69'	400	180	70	60	400	270	20'6"
PRE-FUNCTION	2436 ft.	58' x 42'	n/a	n/a	n/a	n/a	n/a	n/a	8'4"
THE CENTURY ROOM AB	4440 ft.	74' x 60'	650	280	80	78	600	420	17'
CENTURY ROOM A	2220 ft.	37' x 60'	325	150	55	54	300	210	17'
CENTURY ROOM B	2220 ft.	37' x 60'	325	150	55	4	300	210	17'
PRE-FUNCTION	1632 ft.	16' x 102'	n/a	n/a	n/a	n/a	n/a	n/a	10'10"
SAM RAYBURN	2200 ft.	44' x 50'	80	150	60	54	250	200	10'
SECTION A	1100 ft.	22' x 50'	140	70	36	36	120	100	10'
SECTION B	1100 ft.	22' x 50'	140	70	36	36	120	100	10'
JOHN NEELY BRYAN	826 ft.	29' x 28.6'	90	40	28	24	50	50	10'